

# MSA Mid-Size Manual Spray Gun

Designed to help reduce operator fatigue while offering excellent comfort and control, the MSA mid-size spray gun is lighter and more compact than our standard-size JGA gun. That means you get the same quality and high-efficiency performance provided by our JGA-Plus spray gun, in a smaller model that weighs only 17 ounces.

- 300-grade stainless steel fluid passages offer waterborne compatibility, corrosion resistance and protection from harsh self-etching primers.
- Air caps and replacement parts are interchangeable with JGA spray guns (the air inlet fitting is the only exception).

## Productivity and Finish Quality

The productivity and finish quality of any DeVilbiss conventional air spray gun are determined by the air cap and fluid tip combination.

## Ordering Information

The MSA Mid-Size spray gun is available with the following air cap and fluid tip set ups, factory-assembled for immediate delivery. However, these are only the most popular set-ups, other air cap and tip combinations can be ordered separately.

### Part No.

MSA-510-30EX  
MSA-510-35LFF  
MSA-510-35LFX  
MSA-510-704FF  
MSA-510-704FX  
MSA-510-797FF  
MSA-510-797FX

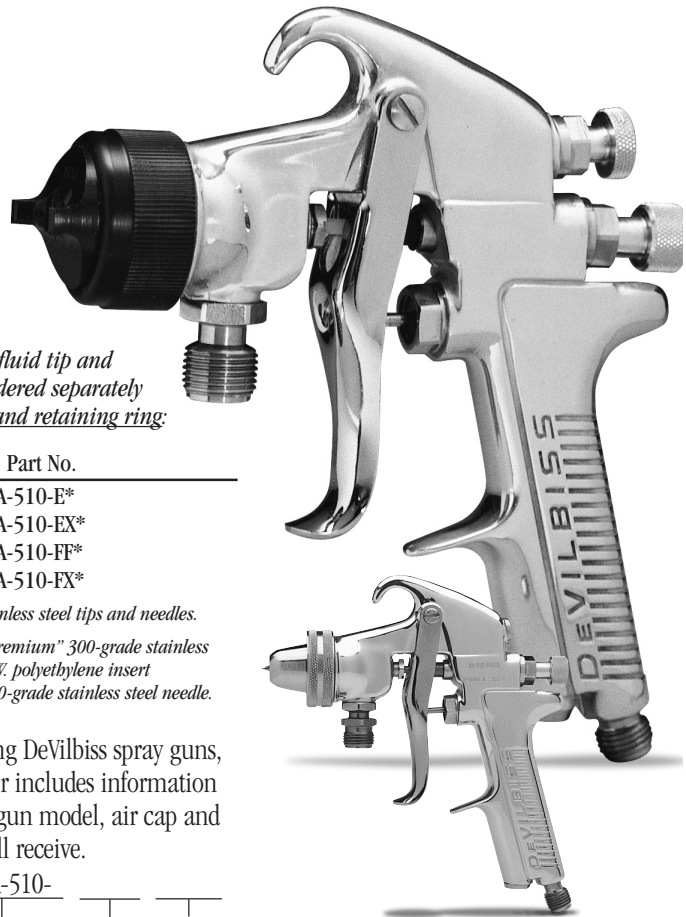

*These guns with fluid tip and needle can be ordered separately without air cap and retaining ring:*

### Part No.

MSA-510-E\*  
MSA-510-EX\*  
MSA-510-FF\*  
MSA-510-FX\*

\* Models include stainless steel tips and needles.

\*\* Models include "premium" 300-grade stainless steel tip with U.H.M.W. polyethylene insert (needle seat) and 300-grade stainless steel needle.

When ordering DeVilbiss spray guns, the part number includes information on the specific gun model, air cap and fluid tip you will receive.

Example: MSA-510-

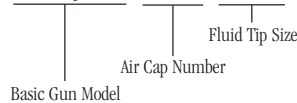

## Technical Specifications

Body:	Drop forged aluminum
Weight:	17 oz. (476 gr)
Air Inlet:	100 psi max, 1/4" NPS (M)
Fluid Inlet:	150 psi max, 3/8" NPS (M)
Fluid Passages:	300-grade stainless steel
Feed Type:	Pressure feed Suction feed
Service Bulletin:	SB-2-257
Gun Repair Kit:	KK-4987-2

## Accessories

- Hose assemblies, air control, pressure tanks, cups, gun and hose cleaning equipment and other accessories are also available.

## Decorator Spray Gun

### MSA-510-DEC

The MSA-510-DEC decorator spray gun features a spatter cap to create decorative textured finishes.

## Technical Specifications

Body:	Drop forged aluminum
Weight:	18.4 oz. (515 gr)
Air Inlet:	100 psi max, 1/4" NPS (M)
Fluid Inlet:	150 psi max, 3/8" NPS (M)
Fluid Passages:	300-grade stainless steel
Wetted Parts:	300 and 400-grade stainless steel Hardened alloy
Feed Type:	Pressure feed
Service Bulletin:	SB-2-319
Gun Repair Kit:	KK-4987-2

**PARTS LIST**

Ref. No.	Part No.	Description	Individual Parts Req.
1	MBC-231	Retaining Nut	1
2	AV-447	Spatter Cap Assembly (Flat)	1
3	---	Cap	1
4	---	Ring	1
5	---	Gasket	1
6	MSV-3-K10	Gasket, Teflon (Blue) (Kit of 10)	1
7	JGA-4040-VF	Fluid Tip and Needle, Matched (Includes Item 28)	1
8	---	Lock Nut	1
9	---	Fluid Inlet Adapter	1
10	JGA-4044	Fluid Inlet and Nut Kit	1
11	JGV-463-K3	Needle Packing (Kit of 3)	1
12	34411-122-K10	Packing Gland (Kit of 10)	1
13	---	Trigger Bearing Stud	1
14	---	Screw	1
15	JGS-478	Stud and Screw Kit (3 studs and 5 screws in kit)	1
16	JGA-477	Trigger, Stud and Screw Kit (Kit includes 1 each)	1
17	JGA-14-K25	Snap Ring (Kit of 25)	1
18	JGA-15-K25	Washer (Kit of 25)	1
19	JGS-26-K25	U Cup Seal (Kit of 25)	1
20	JGS-431-K25	Air Valve (Kit of 25)	1
21	MBD-12-K25	Spring (Kit of 25)	1
22	JGS-72-K10	Gasket (Kit of 10)	2
23	JGS-449-1	Air Valve Assembly	1
24	JGA-132	Plug	2

Ref. No.	Part No.	Description	Individual Parts Req.
25	MSA-3	Nipple	1
26	GTI-33-K5	Seal Kit (Kit of 5)	1
27	JGA-4074	Baffle Assembly	1
28	---	Fluid Needle (Included with Item 7)	1
29	---	Bushing	1
30	MBD-19-K10	Spring (Kit of 10)	1
31	---	Spring Pad (Included with Item 30)	1
32	TGHV-15	Fluid Needle Adjusting Screw	1
33	JGA-4041	Bushing, Spring & Knob Kit	1

•These parts are included in Repair Kit KK-4987-2 and should be kept on hand for service convenience.  
 Suffixes - K5, K10 designate kits of multiple parts.  
 (Example) JGV-463-K3 is a kit of 3 packings.

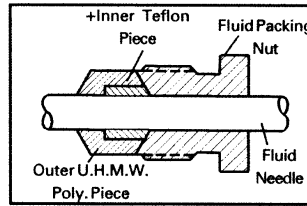

▲ (Ref. No. 11) Needle Packing (2 piece packing) covered by U.S. Patent No. 5,209,501.  
 +Tapered edge faces out towards packing nut.

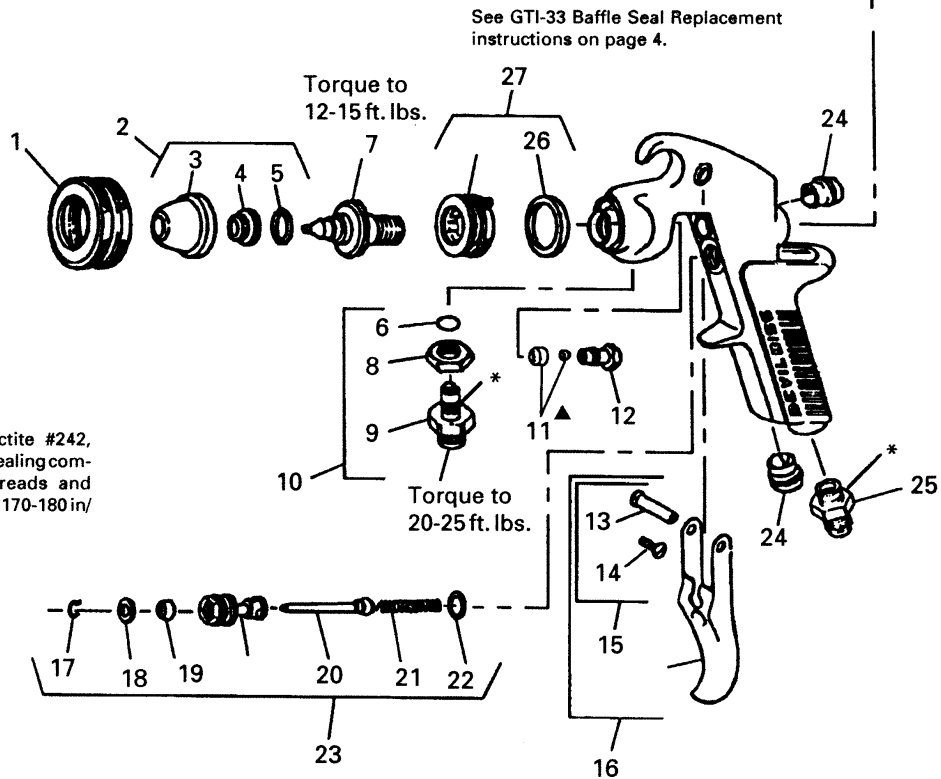
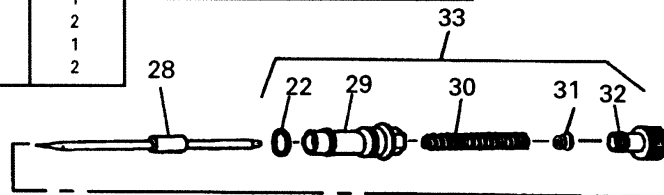

**Note**

\*Apply QH-130 (Loctite #242, med. strength blue) sealing compound onto the threads and screw into place with 170-180 in/lb. torque.

